



Service Manual

Horizontal Freezer

CF 41 T

| Model Version | | Page |
|--------------------------|----------------------------|-------------|
| CF 41 T | | |
| 8549 530 66000 | | |
| | Technical data | 2 |
| | Spare part list | 3 |
| | Exploded view | 4 |
| | Circuit and Wiring diagram | 5 |

Technical data

Dimensions

| | | |
|--------|------|----|
| Height | 88.4 | cm |
| Width | 112 | cm |
| Depth | 64.2 | cm |

Capacity

| | | |
|-------|-----|---|
| gross | 390 | l |
|-------|-----|---|

Electrical connection

| | | |
|-----------|-----------|----|
| Voltage | 110 - 127 | V |
| Frequency | 50 - 60 | Hz |

Compressor

| | | |
|--------------------|----------|---|
| Type | B 1116 Z | |
| Capacity (CECOMAF) | 136 | W |

Refrigerant

| | | |
|----------|---------|---|
| Type | R 134 a | |
| Quantity | 145 | g |

Thermostat switching value

| | | |
|-----------------------------|--------|----|
| Switch on temperature min. | - 14 | °C |
| Switch on temperature max. | - 23.5 | °C |
| Switch off temperature min. | - 20 | °C |
| Switch off temperature max. | - 29.5 | °C |

Spare part list

Model CF 41 T
Service No. 854953066000
Version 854953066000

| Pos. No. | 12NC Code | Description |
|-----------------|-----------------------|-------------------------|
| 012 0 | 4819 528 78036 | Foot |
| 040 0 | 4819 417 19607 | Hinge |
| 040 7 | 4819 462 58187 | Cover,hinge |
| 040 8 | 4819 462 58354 | Cover,hinge |
| 070 7 | 4819 458 58384 | Grid,air |
| 101 0 | 4819 442 69253 | Door,freezer |
| 111 0 | 4819 498 78464 | Handle,door |
| 111 1 | 4819 462 88135 | Handle,cover |
| 130 2 | 4819 417 38118 | Lock |
| 130 3 | 4819 401 18332 | Hook |
| 130 4 | 4819 532 58291 | Washer |
| 130 5 | 4819 462 58402 | Cover ,lock |
| 130 6 | 4819 404 79522 | Support |
| 191 4 | 4819 468 18201 | Gasket |
| 204 3 | 4819 442 78468 | Separator |
| 241 0 | 4819 458 68203 | Basket |
| 252 0 | 4819 464 18155 | Casing |
| 301 0 | 4819 459 48702 | Control cover |
| 321 0 | 4819 381 18108 | Lens red |
| 321 1 | 4819 381 18246 | Lens |
| 335 0 | 4819 411 28789 | Knob thermostat |
| 350 0 | 4819 134 48511 | Pilot lamp |
| 402 0 | 4819 360 38628 | Compressor B1116Z |
| 442 0 | 4819 361 78222 | Motor,fan 115v |
| 442 1 | 4819 404 79496 | Bracket |
| 443 0 | 4819 515 38001 | Fan wheel |
| 491 0 | 4819 462 79046 | Lid f. connection block |
| 561 0 | 4812 280 68316 | Monoblock AD41FR4 |
| 561 2 | 4819 290 68198 | Connectionblock |
| 566 2 | 4819 271 28766 | Thermostat A 1082 R4523 |
| 614 0 | 4819 280 68211 | Relay 115 V |
| 740 0 | 4819 511 48648 | Condenser |
| 740 4 | 4819 404 79545 | Holder |
| 764 0 | 4819 480 28144 | Dryer |
| 781 0 | 4819 462 88134 | Panel f.drain |
| 934 2 | 4819 492 68431 | Spring |

Exploded view

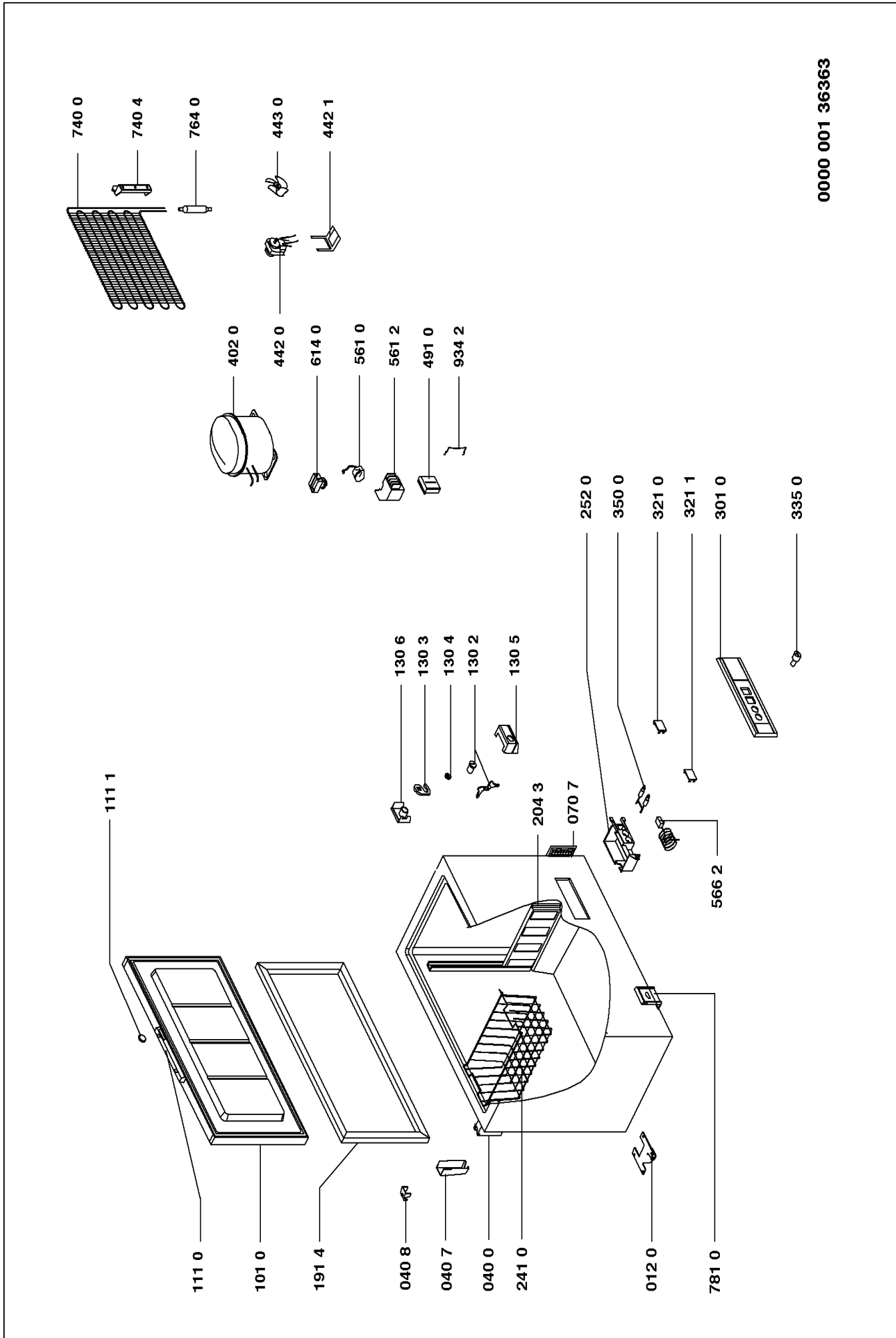

0000 001 36363

Circuit and Wiring diagram

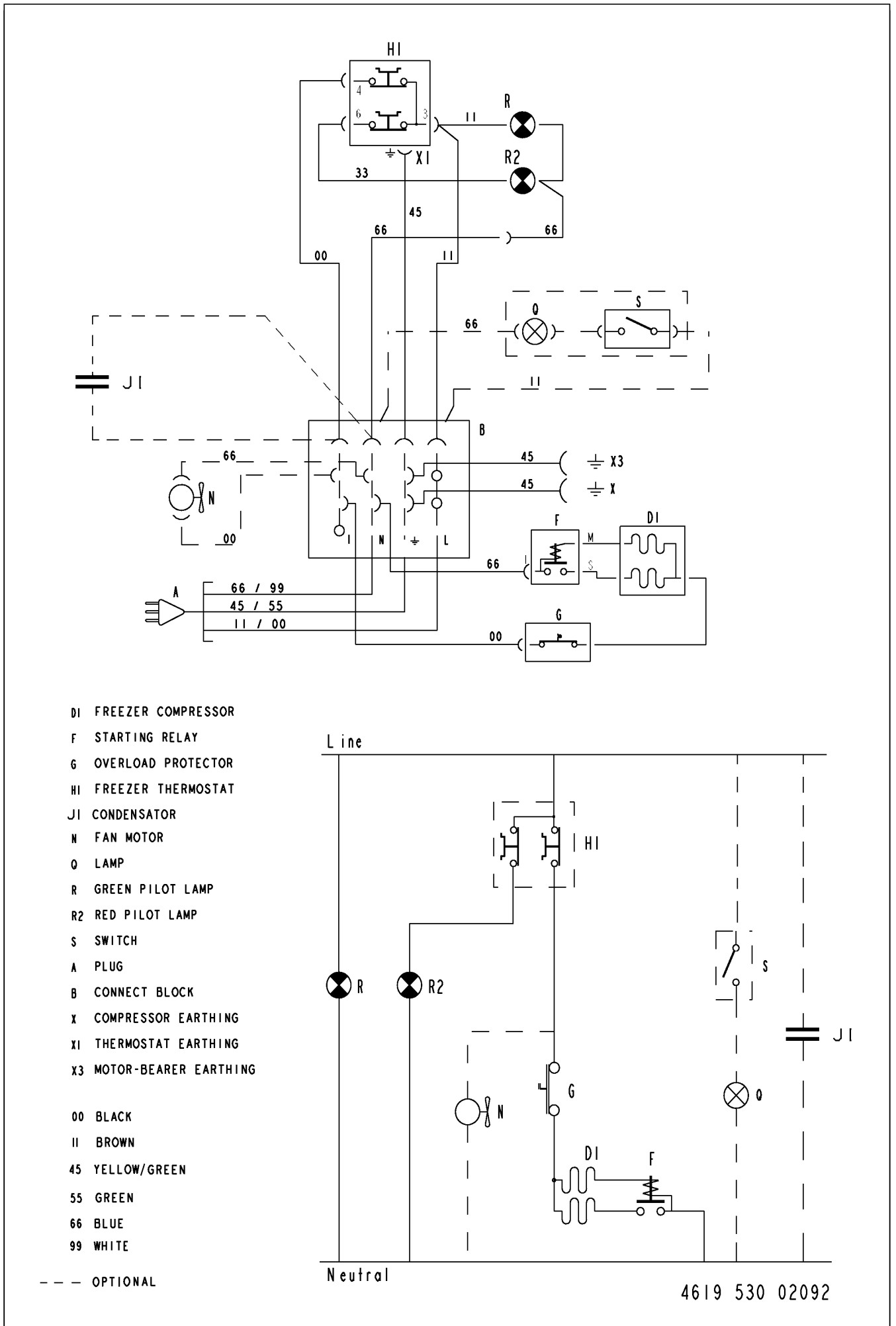

- DI FREEZER COMPRESSOR
- F STARTING RELAY
- G OVERLOAD PROTECTOR
- HI FREEZER THERMOSTAT
- J1 CONDENSATOR
- N FAN MOTOR
- Q LAMP
- R GREEN PILOT LAMP
- R2 RED PILOT LAMP
- S SWITCH
- A PLUG
- B CONNECT BLOCK
- X COMPRESSOR EARTHING
- X1 THERMOSTAT EARTHING
- X3 MOTOR-BEARER EARTHING

- 00 BLACK
- 11 BROWN
- 45 YELLOW/GREEN
- 55 GREEN
- 66 BLUE
- 99 WHITE

--- OPTIONAL

